

AMERICAN MOTORS PARTS CATALOG

GROUP 7 SHIFTING

BALL, Gear Shift Upper Lever	7-3	7.020
BELLCRANK, Gear Shift	7.110
BOOT, Gear Selector Lever	7-4	7.245
BOOT, Transmission Brake Cable	7-4	7.250
BRACKET, Gear Selector Cable Lower	7-4	7.240
BRACKET, Gear Selector Light Socket	7-4	7.225
BRACKET, Gear Shift Operating Shaft Bearing	7-2, 7-3	7.042
BULB, Gear Selector Dial Light	7-4	7.535
BUTTON, Transmission Shifting Gear Selector	7-4	7.200
CABLE, Transmission Brake	7-4	7.235
CABLE, Transmission Gear Selector	7-4	7.230
CONTROL, Gear Selector Transmission	7-4, 0-14	7.210
DIAL, Gear Selector Pointer	7.537
ESCUTCHEON, Gear Selector Push Button	7-4	7.215
FULCRUM, Gear Shift Operating Shaft	7-2, 7-3	7.044
GROMMET, Gear Shift Lever	6-1, 6-3	7.138
GROMMET, Gear Shift Operating Lever	7-2, 7-3	7.088
HANDLE, Transmission Brake Lever	7-4, 0-14	7.205
KNOB, Gear Shift Lever	7-1, 7-3	7.030
LEVER, Gear Shift	6-1, 6-2, 6-3	7.130
LEVER, Gear Shift Operating Shaft	7-2, 7-3	7.085
LEVER, Gear Shift Upper	7-1, 7-3	7.020
LINK, Gear Shift Bellcrank to Lever	7.115
PAD, Gear Selector Push Button Escutcheon Felt	7-4	7.215
PIN, Gear Shift Operating Shaft Connecting	7-1, 7-2	7.038
PLUG, Transmission Brake and Gear Selector Cable Hole	7-4	7.237
POINTER, Gear Selector	7-3	7.536
RETAINER, Gear Shift Lever Pressure Spring	7-3	7.025
ROD, Gear Shift	7-2, 7-3	7.125
SEAL, Transmission Brake and Gear Selector Cable Hole	7-4	7.237
SHAFT, Gear Shift Bellcrank	7.105
SHAFT, Gear Shift Operating	7-1, 7-2, 7-3	7.038
SHROUD, Gear Selector Pointer Dial	7.537
SNUBBER, Gear Shift Upper Lever	7-1	7.020
SOCKET, Gear Selector Dial Light	7-4	7.535
SOCKET, Gear Shift Upper Lever	7-1	7.020
SPACER, Gear Shift Operating Lever Seal	7-2	7.089
SPACER, Gear Shift Operating Shaft Spring	7-3	7.085
SPRING, Gear Shift Lever Pressure	7-1, 7-3	7.025
SPRING, Gear Shift Operating Shaft	7-2, 7-3	7.039
SPRING, Transmission Brake Cable	7-4	7.235
SUPPORT, Gear Shift Operating Shaft Bearing	7-3	7.042
TRUNNION, Gear Selector Cable	7-4	7.255
TRUNNION, Gear Shift Rod	7-2, 7-3	7.135
U-BOLT, Gear Shift Operating Shaft Bearing Bracket	7-2, 7-3	7.042

AMERICAN MOTORS PARTS CATALOG

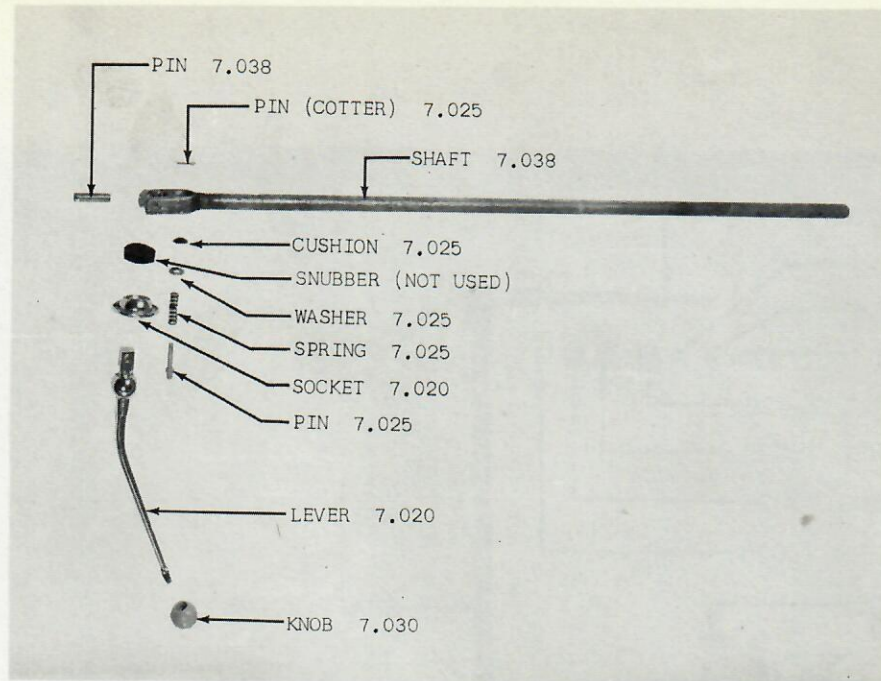

GROUP 7 - FIG. 1 - GEAR SHIFT LINKAGE (UPPER) 01 (LAT)

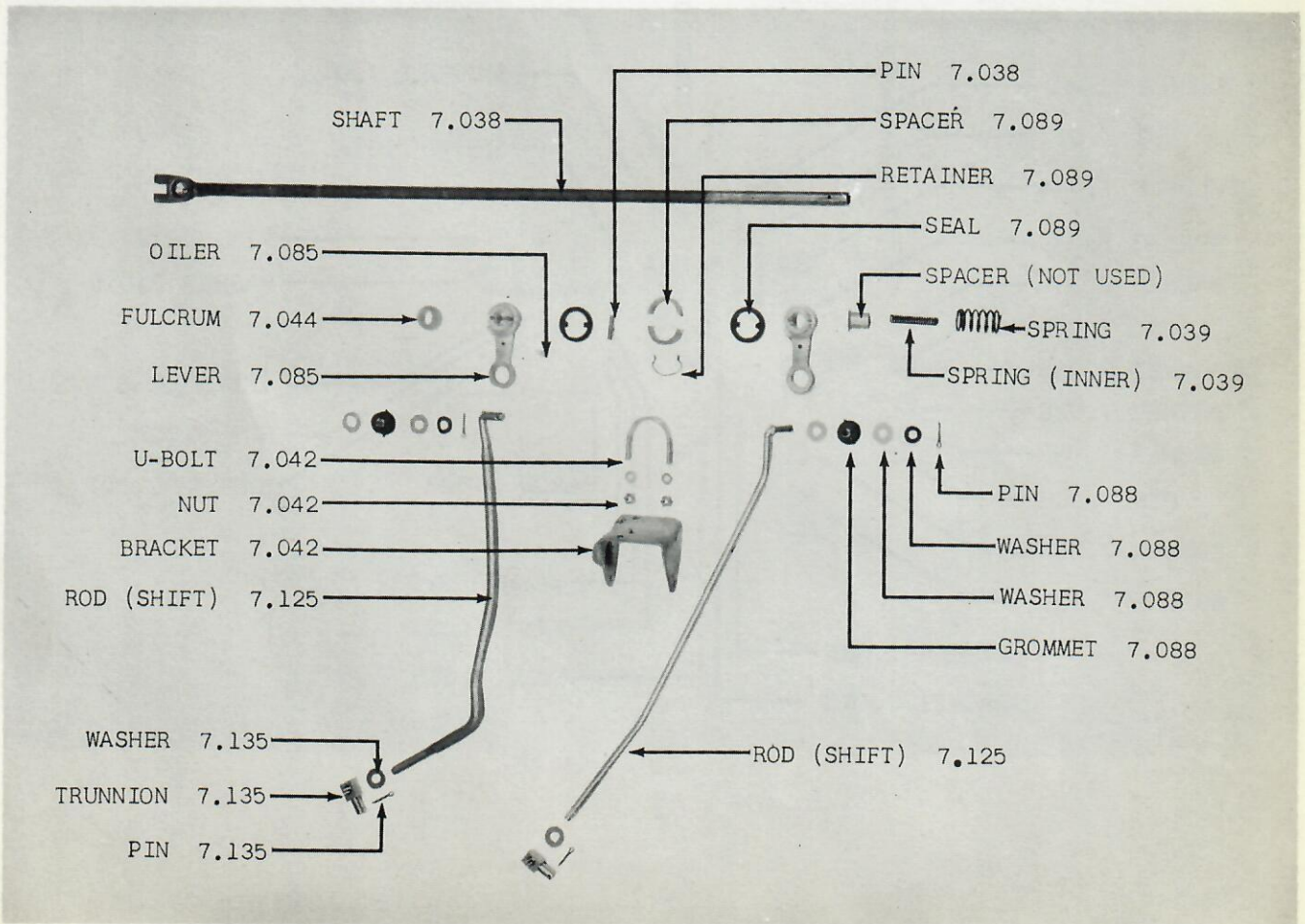

GROUP 7 - FIG. 2 - GEAR SHIFT LINKAGE (LOWER) 01 (LAT)

AMERICAN MOTORS PARTS CATALOG

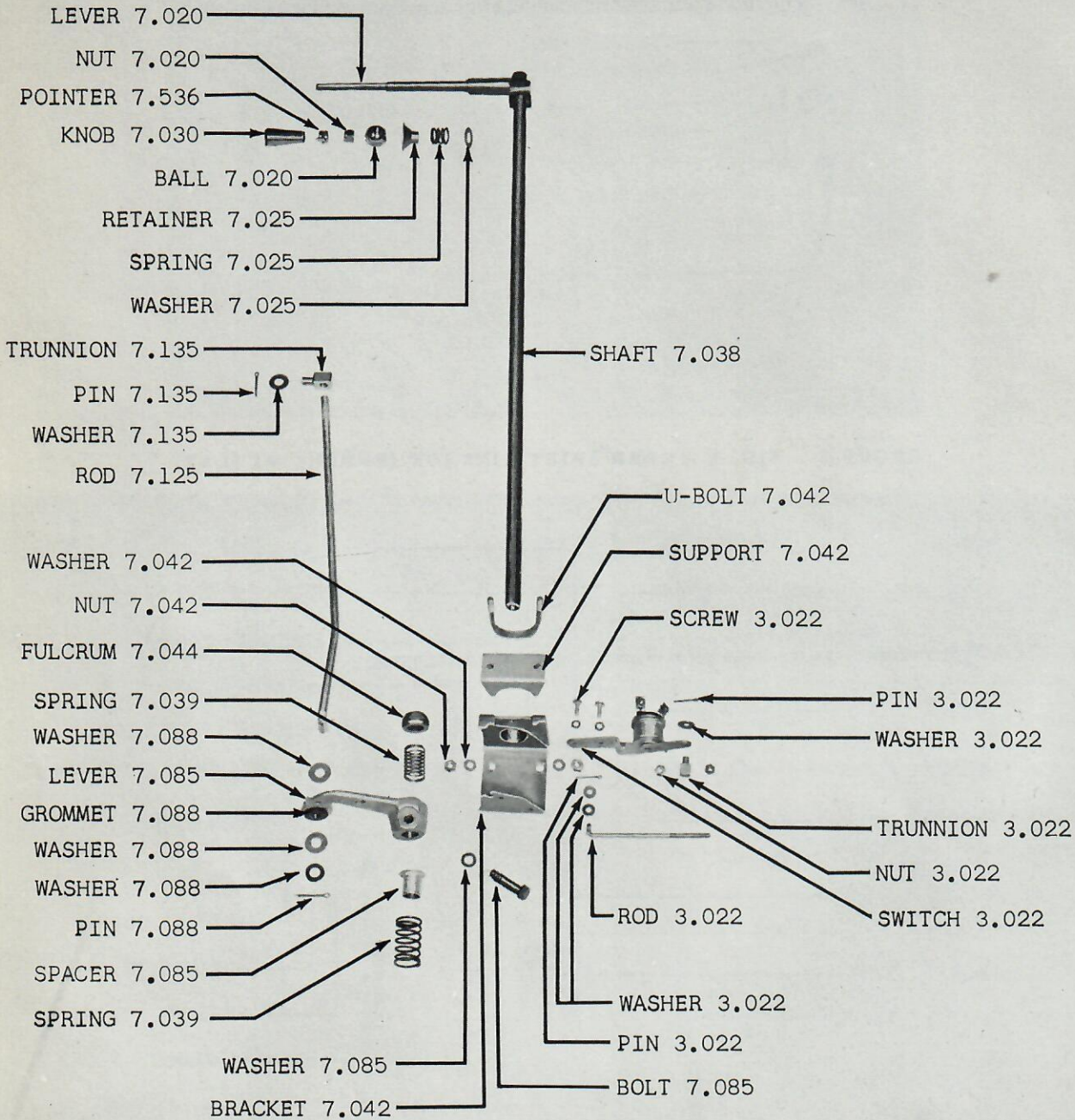

AMERICAN MOTORS PARTS CATALOG

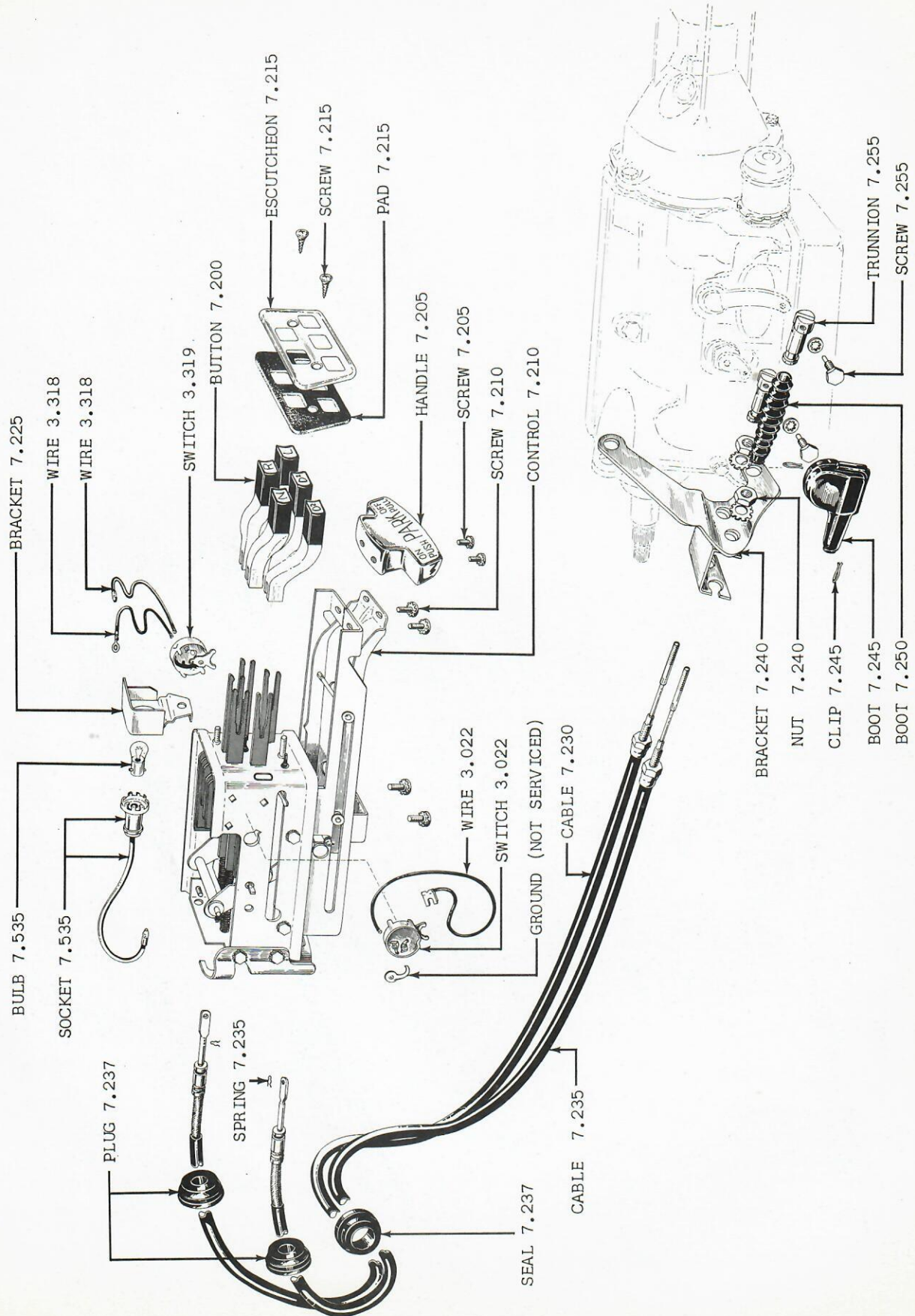

GROUP 7 - FIG. 4 - PUSH BUTTON SHIFTING 10-20-80 (WAT)

AMERICAN MOTORS PARTS CATALOG

7.042

DESCRIPTION	YEAR AND MODEL	PER CAR	PART NO.
GROUP 7 SHIFTING			
7.020 LEVER, Gear Shift Upper			
LEVER (Painted).....	59 01 (WST)(WOD).....	1	315 5672
(Chrome).....	59 01 (WAT).....	1	315 5671
	59 10-20-80 (WST)(WOD).....	1	315 5841
SOCKET, Ball.....	59 10-20-80 (WST)(WOD).....	1	314 6409
BALL.....	59 01.....	1	313 0243
DAMPENER.....	59 10-20-80 (WST)(WOD).....	1	315 6470
BRACKET (Incl. Trim Ring).....	59 01.....	1	437 6769
RING, Trim (Plain).....	59 01.....	1	340 0589
NUT.....	59 01 (WAT).....	1	313 2760
	59 01 (WST)(WOD).....	1	314 3147
7.025 SPRING, Gear Shift Lever Pressure			
SPRING.....	59 01.....	1	313 0247
	59 10-20-80 (WST)(WOD).....	1	312 5492
RETAINER.....	59 01.....	1	313 0244
PIN.....	59 10-20-80 (WST)(WOD).....	1	312 5490
Cotter.....	59 10-20-80 (WST)(WOD).....	1	G103361
CUSHION, Pin.....	59 10-20-80 (WST)(WOD).....	1	312 6951
WASHER (Plain).....	59 01.....	1	800 0190
	59 10-20-80 (WST)(WOD).....	1	G120391
7.030 KNOB, Gear Shift Lever			
KNOB.....	59 01: 59 10-20-80 (WST)(WOD).....	1	315 5840
DAMPENER.....	59 10-20-80 (WST)(WOD).....	1	315 8408
7.038 SHAFT, Gear Shift Operating			
SHAFT.....	59 01 (WST)(WOD).....	1	315 6384
	59 01 (WAT).....	1	315 6401
	59 10-20 (LHD-WST)(LHD-WOD).....	1	315 6395
	59 10 (RHD-WST)(RHD-WOD): 59 80 (WST)(WOD)...	1	315 6397
PIN, Spring.....	59 01-10-20-80 (WST)(WOD).....	1	312 5486
(Lower).....	59 01-10-20-80 (WST)(WOD).....	1	312 5489
Lever Connection.....	59 10-20-80 (WST)(WOD).....	1	312 5488
Shaft Yoke.....	59 01.....	1	313 0245
SEAL, Opening.....	59 10 (LHD-WST)(LHD-WOD): 59 20-80 (WST)(WOD)	1	315 5867
	59 01 (WST)(WOD).....	1	312 7375
7.039 SPRING, Gear Shift Operating Shaft			
SPRING (Inner).....	59 01-10-20-80 (WST)(WOD).....	1	312 5483
	59 01 (WAT).....	1	312 8632
(Outer).....	59 01-10-20-80 (WST)(WOD).....	1	315 6386
	59 01 (WAT).....	1	312 7191
7.042 BRACKET, Gear Shift Operating Shaft Bearing			
BRACKET.....	59 01 (WAT).....	1	315 6398
	59 01-10-20-80 (WST)(WOD).....	1	315 6300
U-BOLT.....	59 01 (WAT).....	1	314 6377

AMERICAN MOTORS PARTS CATALOG

NUT. U-Bolt.....	59 01-10-20-80 (WST)(WOD).....	1	315 6385
WASHER (Lock).....	59 01: 59 10-20-80 (WST)(WOD).....	2	G120367
	59 01: 59 10-20-80 (WST)(WOD).....	2	G120380
7.044 FULCRUM, Gear Shift Operating Shaft			
FULCRUM.....	59 01: 59 10-20-80 (WST)(WOD).....	1	312 5484
7.085 LEVER, Gear Shift Operating Shaft			
LEVER.....	59 01 (WAT).....	1	315 4781
(Upper)(Second And High).....	59 01-20-80 (WST)(WOD):		
	59 10 (LHD-WST)(LHD-WOD).....	1	315 6368
	59 10 (RHD-WST)(RHD-WOD).....	1	315 6478
(Lower)(Low And Reverse).....	59 01-20-80 (WST)(WOD):		
	59 10 (LHD-WST)(LHD-WOD).....	1	315 6367
	59 10 (RHD-WST)(RHD-WOD).....	1	315 6480
OILER.....	59 01-20-80 (WST)(WOD): 59 10 (LHD-WST)		
	(LHD-WOD).....	1	315 6388
	59 10 (RHD-WST)(RHD-WOD).....	1	G274509
SPACER.....	59 01 (WAT).....	1	315 4777
	59 01-10-20-80 (WST)(WOD).....	1	315 8682
BOLT.....	59 01 (WAT).....	1	312 8665
WASHER (Lock).....	59 01 (WAT).....	1	G120214
7.088 GROMMET, Gear Shift Operating Lever			
GROMMET.....	59 01-10-20-80 (WST)(WOD).....	2	312 9623
	59 01 (WAT).....	1	312 9623
WASHER (Plain).....	59 01-10-20-80 (WST)(WOD).....	4	800 0161
	59 01 (WAT).....	2	800 0161
(Spring).....	59 01-10-20-80 (WST)(WOD).....	4	312 1635
	59 01 (WAT).....	2	312 1635
PIN, Cotter.....	59 01-10-20-80 (WST)(WOD).....	4	G103373
	59 01 (WAT).....	2	G103373
7.089 SEAL, Gear Shift Operating Lever Dirt			
SEAL.....	59 01-20-80 (WST)(WOD):		
	59 10 (LHD-WST)(LHD-WOD).....	1	315 6387
	59 10 (RHD-WST)(RHD-WOD).....	1	315 6477
7.105 SHAFT, Gear Shift Bellcrank			
SHAFT.....	59 10 (RHD-WST)(RHD-WOD).....	1	313 0630
WASHER (Plain)(17/32 x 1 x 5/64).....	59 10 (RHD-WST)(RHD-WOD).....	1	800 0193
(13/32 x 13/16 x 1/16).....	59 10 (RHD-WST)(RHD-WOD).....	1	G120394
(Lock).....	59 10 (RHD-WST)(RHD-WOD).....	1	311 8257
NUT.....	59 10 (RHD-WST)(RHD-WOD).....	1	G124925
Lock.....	59 10 (RHD-WST)(RHD-WOD).....	1	G107823
7.110 BELLCRANK, Gear Shift			
BELLCRANK.....	59 10 (RHD-WST)(RHD-WOD).....	2	313 4681
SPACER.....	59 10 (RHD-WST)(RHD-WOD).....	1	310 7638
BRACKET.....	59 10 (RHD-WST)(RHD-WOD).....	1	341 6924

AMERICAN MOTORS PARTS CATALOG

7.200

7.115 LINK, Gear Shift Bellcrank To Lever

LINK (Second And High).....	59 10 (RHD-WST)(RHD-WOD).....	1 314 6861
(Low And Reverse).....	59 10 (RHD-WST)(RHD-WOD).....	1 314 6862
WASHER (Plain).....	59 10 (RHD-WST)(RHD-WOD).....	8 800 0163
PIN, Cotter.....	59 10 (RHD-WST)(RHD-WOD).....	4 G103373

7.125 ROD, Gear Shift

ROD.....	59 01 (WAT).....	1 315 6408
(Second And High).....	59 01 (WST)(WOD).....	1 315 6418
	59 10 (LHD-WST)(LHD-WOD).....	1 315 6374
	59 10 (RHD-WST)(RHD-WOD).....	1 314 6338
	59 10 (WST-Heavy Duty)(Note 7.125-1).....	1 315 6463
	59 20 (WST)(WOD).....	1 315 6372
	59 80 (WST)(WOD).....	1 315 6370
(Low And Reverse).....	59 01 (WST)(WOD).....	1 315 6419
	59 10 (LHD-WST)(LHD-WOD).....	1 315 6373
	59 10 (RHD-WST)(RHD-WOD).....	1 315 6247
	59 10 (WST-Heavy Duty)(Note 7.125-1).....	1 315 6464
	59 20 (WST)(WOD).....	1 315 6371
	59 80 (WST)(WOD).....	1 315 6369

7.130 LEVER, Gear Shift (On Transmission)

LEVER (Second And High).....	59 01 (WST)(WOD).....	1 315 5836
	59 10 (WST)(WOD).....	1 315 5838
	59 10 (WST-Heavy Duty)(Note 7.125-1):	
	59 20 (WST)(WOD).....	1 315 5834
	59 80 (WST)(WOD).....	1 315 5833
(Low And Reverse).....	59 01-80 (WST)(WOD).....	1 315 5837
	59 10-20 (WST)(WOD).....	1 315 5835
NUT.....	59 01-10-20-80 (WST)(WOD).....	2 G120376
WASHER (Plain).....	59 01-10-20-80 (WST)(WOD).....	2 G103340
(Lock).....	59 01-10-20-80 (WST)(WOD).....	2 G120214

7.135 TRUNNION, Gear Shift Rod

TRUNNION.....	59 01 (WAT).....	1 315 1188
	59 01-10-20-80 (WST)(WOD).....	2 315 5096
WASHER (Plain).....	59 01 (WAT).....	1 800 0161
	59 01-10-20-80 (WST)(WOD).....	2 800 0161
PIN (Cotter).....	59 01 (WAT).....	1 G103373
	59 01-10-20-80 (WST)(WOD).....	2 G103373

7.200 BUTTON, Transmission Shifting Gear Selector

BUTTON "Neutral Start".....	59 10-20-80 (WAT).....	1 343 5291
"Reverse".....	59 10-20-80 (WAT).....	1 343 5292
"Low".....	59 10-20-80 (WAT).....	1 343 0584
"Drive 1".....	59 10-20-80 (WAT).....	1 343 0585
"Drive 2".....	59 10-20-80 (WAT).....	1 343 0586

NOTE 7.125-1: 59 10 (WST) Cars having a production installed Heavy Duty Package may be identified in the following way:
 The Trunnion at the Transmission end of the Torque Tube is Welded instead of Threaded to the Torque Tube.

AMERICAN MOTORS PARTS CATALOG

7.537

7.240 BRACKET, Gear Selector Cable Lower

BRACKET.....	59 10-20-80 (WAT).....	1	315 4034
NUT, Cable To Bracket.....	59 10-20-80 (WAT).....	2	G124920
WASHER (Lock), Cable To Bracket.....	59 10-20-80 (WAT).....	2	G138485

7.245 BOOT, Gear Selector Lever

BOOT.....	59 10-20-80 (WAT).....	1	315 4029
CLIP.....	59 10-20-80 (WAT).....	2	315 4734

7.250 BOOT, Transmission Brake Cable

BOOT.....	59 10-20-80 (WAT).....	1	313 0356
-----------	------------------------	---	----------

7.255 TRUNNION, Gear Selector Cable

TRUNNION.....	59 10-20-80 (WAT).....	2	315 4030
SCREW.....	59 10-20-80 (WAT).....	2	315 4031
WASHER (Lock).....	59 10-20-80 (WAT).....	2	G120423

7.535 SOCKET, Gear Selector Light

SOCKET (Incl. Wire).....	59 01 (WAT).....	1	342 5968	
	59 10-20-80 (WAT).....	1	343 7549	
BULB (GE 1891).....	59 01 (WAT).....	1	G456985	
	(GE 53).....	59 10-20-80 (WAT).....	1	G131282
	(GE 1445).....	59 10-20-80 (WAT).....	1	344 1593
SUPPORT.....	59 01 (WAT).....	1	313 8299	

7.536 POINTER, Gear Selector

POINTER.....	59 01 (WAT).....	1	313 7355
--------------	------------------	---	----------

7.537 DIAL, Gear Selector Pointer

DIAL.....	59 01 (WAT).....	1	315 4780	
SHROUD.....	59 01 (WAT).....	1	313 7347	
PAD, Dial Retaining.....	59 01 (WAT).....	1	313 8344	
STUD.....	59 01 (WAT).....	2	313 8332	
WASHER (Plain).....	59 01 (WAT).....	1	800 0139	
	(Lock).....	59 01 (WAT).....	2	G131096
	(Rubber).....	59 01 (WAT).....	2	313 0998
NUT.....	59 01 (WAT).....	2	G120614	